

**THERMACUT® REPLACEMENT PARTS SUITABLE FOR
CEBORA®
CP®160**

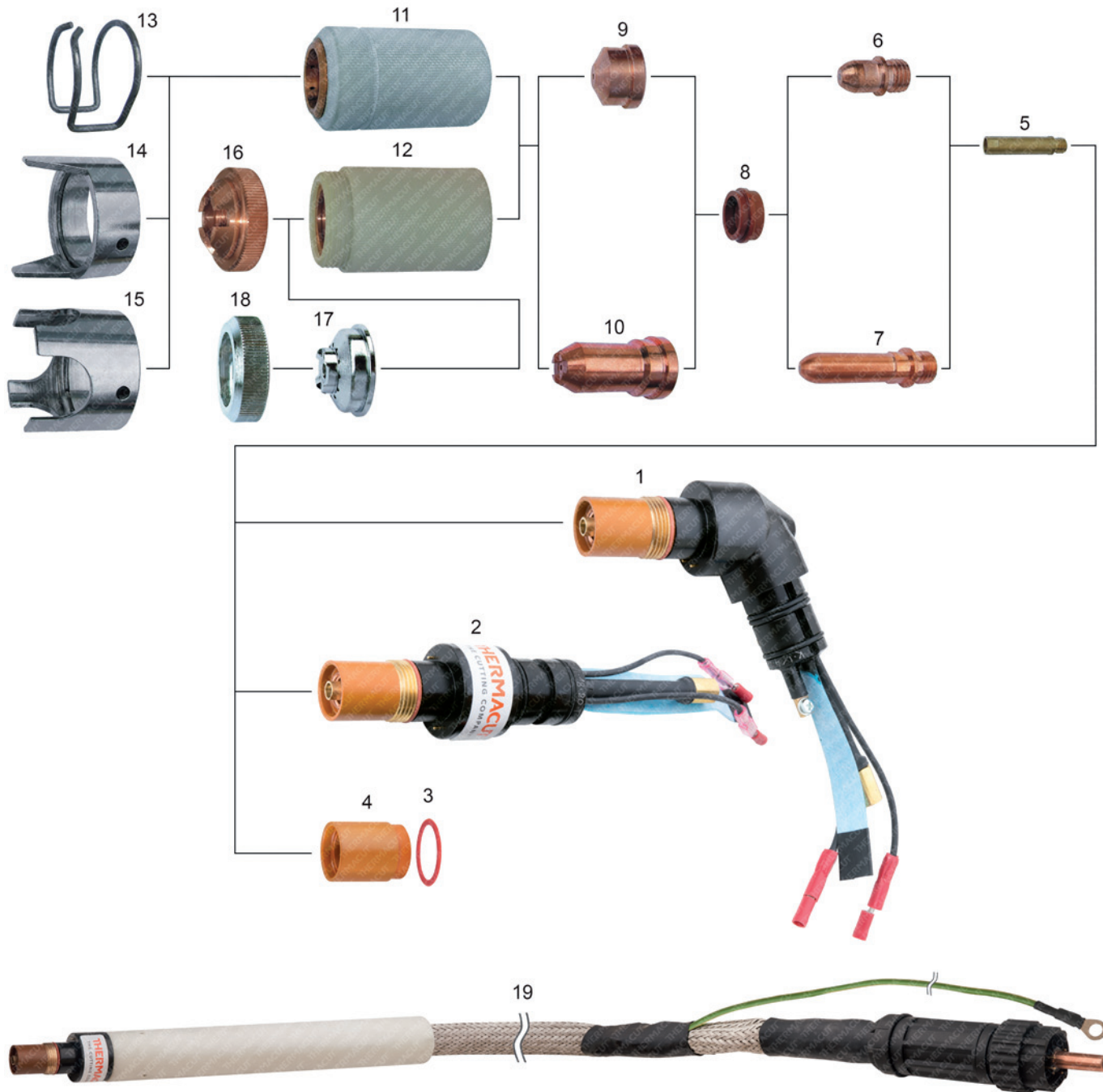

Last update of this page: 28/02/2020. See Revision history for details.

THERMACUT®
THE CUTTING COMPANY

WWW.THERMACUT.CZ
TEL.: +420 556 423 418
SALES@THERMACUT.CZ

WWW.THERMACUT.DE
TEL.: +49 (0) 27 39 40 33 0
INFO@THERMACUT.DE

WWW.THERMACUT.COM
TEL.: 1-603-542-6715
CUSTOMERSERVICE@THERMACUT.COM

THERMACUT®, THE CUTTING COMPANY®, FHT-EX®, EX-TRAFIRE®, EX-TRACK®, EX-TRABEAM® AND EX-TRAFLEAME® ARE REGISTERED TRADEMARKS OF THERMACUT, K.S. AND MAY BE REGISTERED IN CZECH REPUBLIC AND/OR OTHER COUNTRIES. ALL OTHER TRADEMARKS ARE PROPERTIES OF THEIR RESPECTIVE OWNERS. THERMACUT IS NO WAY AFFILIATED WITH CEBORA®.
MOST THERMACUT PARTS ARE MADE FOR OR BY AN IBC COMPANY. PARTS INDICATED WITH A OEM ARE ORIGINAL PARTS MANUFACTURED BY THE ABOVE NAMED MANUFACTURER AND ARE BEING RESOLD BY THERMACUT. THERMACUT RESERVES THE RIGHT TO SUBSTITUTE OEM PARTS IN PLACE OF THERMACUT PARTS.
VALID FROM NOVEMBER 2020 • PREVIOUS VERSION IS NO LONGER VALID. • © COPYRIGHT 2020 BY THERMACUT® CZECH REPUBLIC. ALL RIGHTS RESERVED.

THERMACUT® REPLACEMENT PARTS SUITABLE FOR CEBORA® CP®160

Item	Part No.	Ref. No.	Description	Item	Part No.	Ref. No.	Description
1.	T-8955	1353	Torch Body, Hand	13.	T-0400	1386	Spacer Spring
2.	T-8746	1354	Torch Body, Machine	14.	T-0643	1408	Double Pointed Spacer
3.	T-0411	1398	O-Ring	15.	T-5003	CV14	Crown Spacer
4.	T-9377	40941	Torch Insulator	16.	T-5401	1392	Shield Cup
5.	T-0410	1378	Brass Diffuser	NS	T-5068	TP10	Handle with Switch
6.	T-0408	1376	Electrode	17.	T-9370		Spacer for Contact Cutting
7.	T-0409	1517	Electrode, Long	18.	T-9375		Locking Nut
8.	T-0407	1377	Swirl Ring	NS	KT-1048	1576	CP®160-H Torch with Leads 6m with centr. conn.
	T-8959	1377-CW	Swirl Ring	NS	KT-1057	1571	CP®160-H Torch with Leads 6m, fittings
9.	T-0402	1371	Nozzle 1.1mm 50A	NS	KT-1070	K.CP160H.6M.CK.K	CP®160-H Cable Leads, Hand. 6m with centr. conn.
	T-0403	1372	Nozzle 1.3mm 90A	NS	KT-1083	1578	CP®160-H Hand Torch with Leads 12m with centr. conn.
	T-0404	1373	Nozzle 1.6mm 120A	19.	KT-1128	1577	CP®160-M Mach. Torch with Leads 6m with centr. conn.
	T-0405	1374	Nozzle 1.8mm 160A		KT-1086	1579	CP®160-M Mach. Torch with Leads 12m with centr. conn.
10.	T-0406	1369	Nozzle, Long	NS	KT-1273	K.CP160M.12M.CK.K	CP®160-M Cable Leads, Mach.12m with centr. conn.
11.	T-0401	1389	Retaining Cap	NS	KT-1419	K.CP160M.12M	CP®160-M Mach. Torch with Leads 12m, fittings
12.	T-5400	1390	Contact Nozzle Retaining Cap				Different types of cable leads available on request

NS NOT SHOWN IN THE PICTURE

Last update of this page: 28/02/2020. See Revision history for details.

THERMACUT®
THE CUTTING COMPANY

WWW.THERMACUT.CZ
TEL.: +420 556 423 418
SALES@THERMACUT.CZ

WWW.THERMACUT.DE
TEL.: +49 (0) 27 39 40 33 0
INFO@THERMACUT.DE

WWW.THERMACUT.COM
TEL.: 1-603-542-6715
CUSTOMERSERVICE@THERMACUT.COM

THERMACUT®, THE CUTTING COMPANY®, FHT-EX®, EX-TRAFIRE®, EX-TRACK®, EX-TRABEAM® AND EX-TRAFLEAME® ARE REGISTERED TRADEMARKS OF THERMACUT, K.S. AND MAY BE REGISTERED IN CZECH REPUBLIC AND/OR OTHER COUNTRIES. ALL OTHER TRADEMARKS ARE PROPERTIES OF THEIR RESPECTIVE OWNERS. THERMACUT IS NO WAY AFFILIATED WITH CEBORA®.
MOST THERMACUT PARTS ARE MADE FOR OR BY AN IBC COMPANY. PARTS INDICATED WITH A OEM ARE ORIGINAL PARTS MANUFACTURED BY THE ABOVE NAMED MANUFACTURER AND ARE BEING RESOLD BY THERMACUT. THERMACUT RESERVES THE RIGHT TO SUBSTITUTE OEM PARTS IN PLACE OF THERMACUT PARTS.
VALID FROM NOVEMBER 2020 • PREVIOUS VERSION IS NO LONGER VALID. • © COPYRIGHT 2020 BY THERMACUT® CZECH REPUBLIC. ALL RIGHTS RESERVED.