

REPLACEMENT PARTS SUITABLE FOR TRAFIMET®

A80™/P80™

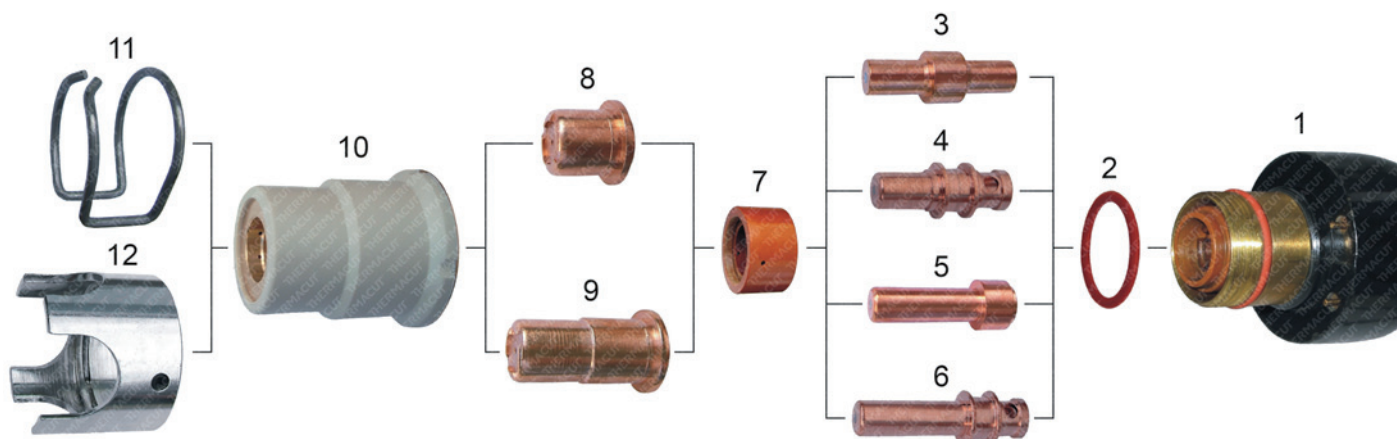

Item	Part No.	Ref. No.	Description	Std. Pkg.	Item	Part No.	Ref. No.	Description	Std. Pkg.
1.	T-5052	PF119	Torch Body - Hand	1	9.	T-5024	PD106-10	Nozzle, Long 1.0mm	5
2.	T-5010	EA125	O-Ring	1	10.	T-5016	PC115	Nozzle Retaining Cap	6
3.	T-5062	PR107	Electrode	5	11.	T-5005	CV28	Spacer Spring	10
4.	T-9216	PR109	Electrode	5	12.	T-5006	CV33	Crown Spacer	10
5.	T-5063	PR108	Electrode, Long	5	NS	T-5442	1356	Handle with Switch	1
6.	T-9804	PR115	Electrode, Long	10	NS	KT-1274	PH130	A80™ Cable Leads 6m, 3/8 fittings	1
7.	T-5042	PE107	Swirl Ring	1	NS	KT-1264	PH132	A80™ Cable Leads 6m, 1/4 fittings	1
8.	T-5022	PD105-10	Nozzle 1.0mm	5	NS	KT-1315	PA171	A80™ Hand Torch with Leads 6m with centr.conn.	1
	T-5023	PD105-12	Nozzle 1.2mm	5					

NS NOT SHOWN IN THE PICTURE

Last update of this page: 27/01/2015. See Revision history for details.

THERMACUT®
THE CUTTING COMPANY

WWW.THERMACUT.CZ
TEL.: +420.556 423 418
SALES@THERMACUT.CZ

WWW.THERMACUT.DE
TEL.: +49 (0) 27 39 40 33 0
INFO@THERMACUT.DE

WWW.THERMACUT.COM
TEL.: 1-603-542-6715
CUSTOMERSERVICE@THERMACUT.COM

THERMACUT®, FHT-EX® AND EX-TRAFIRE® ARE REGISTERED TRADEMARKS OF THERMACUT, K. S. AND MAY BE REGISTERED IN CZECH REPUBLIC AND/OR OTHER COUNTRIES. ALL OTHER TRADEMARKS ARE PROPERTIES OF THEIR RESPECTIVE OWNERS. THERMACUT IS NO WAY AFFILIATED WITH TRAFIMET®. MOST THERMACUT PARTS ARE MADE FOR OR BY AN IBG COMPANY. PARTS INDICATED WITH A OEM ARE ORIGINAL PARTS MANUFACTURED BY THE ABOVE NAMED MANUFACTURER AND ARE BEING RESOLD BY THERMACUT. THERMACUT RESERVES THE RIGHT TO SUBSTITUTE OEM PARTS IN PLACE OF THERMACUT PARTS. VALID FROM JANUARY 2017 • PREVIOUS VERSION IS NO LONGER VALID. • © COPYRIGHT 2017 BY THERMACUT® CZECH REPUBLIC. ALL RIGHTS RESERVED.