

# REPLACEMENT PARTS SUITABLE FOR CEBORA®

## P70™

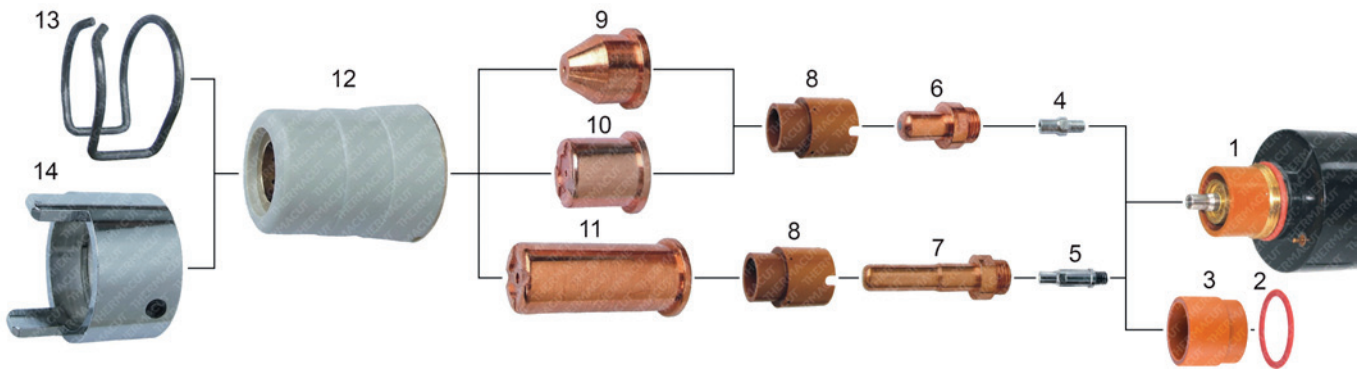

Item	Part No.	Ref. No.	Description	Item	Part No.	Ref. No.	Description
1.	T-1868	1351	Torch Body - Hand	10.	T-4100	1308	Nozzle
	T-1867	1349	Torch Body - Machine		T-1871	1396	Nozzle, Long Life
2.	T-5428	3.160067	O-Ring	11.	T-2979	1395	Nozzle, Long, Long Life
3.	T-8757	1351-4	Torch Insulator	12.	T-5429	5710171	Nozzle Retaining Cap
4.	T-5426	3.065204	Air Diffuser	13.	T-5402	1394	Spacer Spring
5.	PT-10415	1351-1	Air Diffuser, Long	14.	T-5404	1405	Double Pointed Spacer
6.	T-1872	1402	Electrode	NS	T-5442	1356	Handle with Switch
7.	T-5403	1403(1368)	Electrode, Long	NS	KT-1316	1344	HP50™, HP70™ Cable Leads 6m
8.	T-0392	1510	Swirl Ring	NS	KT-1197	1573	HP70™ Torch with Leads 6m with centr. conn.
9.	T-0389	1305	Nozzle, Conical				Different types of cable leads available on request

## CP®200

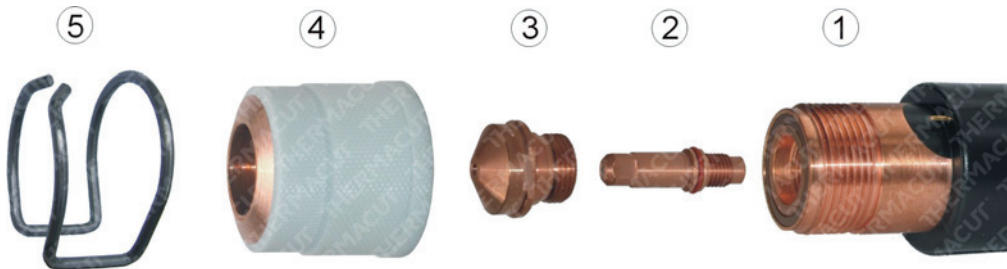

Item	Part No.	Ref. No.	Description	Item	Part No.	Ref. No.	Description
1.	T-5440	1357	Machine Torch	5.	T-0400	1386	Spacer Spring
2.	T-9688	1367	Electrode	NS	KT-1319	1235	CP®200 Mach. Torch with Leads 4m, fittings
3.	T-5420	1842	Nozzle, 1.0 mm	NS	KT-1320	K.CP200.4M.K	CP®200 Cable Leads 4m, fittings
	T-5421	1843	Nozzle, 1.3 mm	NS	KT-1321	K.CP200.6M.CK.K	CP®200 Cable Leads 6m with centr. conn.
	T-5422	1844	Nozzle, 1.6 mm	NS	KT-1125	1234	CP®200 Mach. Torch with Leads 6m with centr. conn.
	T-5423	1845	Nozzle, 1.8 mm	NS	KT-1103	1234.10	CP®200 Mach. Torch with Leads 9m with centr. conn.
4.	T-5424	1905	Shield Cap	NS	KT-1104	K.CP200.9M.CK.K	CP®200 Cable Leads 9m with centr. conn.

NS NOT SHOWN IN THE PICTURE

Last update of this page: 18/05/2017. See Revision history for details.

**THERMACUT®**  
THE CUTTING COMPANY

WWW.THERMACUT.CZ  
TEL.: +420 556 423 418  
SALES@THERMACUT.CZ

WWW.THERMACUT.DE  
TEL.: +49 (0) 27 39 40 33 0  
INFO@THERMACUT.DE

WWW.THERMACUT.COM  
TEL.: 1-603-542-6715  
CUSTOMERSERVICE@THERMACUT.COM

THERMACUT®, FHT-EX® AND EX-TRAFIRE® ARE REGISTERED TRADEMARKS OF THERMACUT, K. S. AND MAY BE REGISTERED IN CZECH REPUBLIC AND/OR OTHER COUNTRIES. ALL OTHER TRADEMARKS ARE PROPERTIES OF THEIR RESPECTIVE OWNERS. THERMACUT IS NO WAY AFFILIATED WITH CEBORA®. MOST THERMACUT PARTS ARE MADE FOR OR BY AN IBG COMPANY. PARTS INDICATED WITH A OEM ARE ORIGINAL PARTS MANUFACTURED BY THE ABOVE NAMED MANUFACTURER AND ARE BEING RESOLD BY THERMACUT. THERMACUT RESERVES THE RIGHT TO SUBSTITUTE OEM PARTS IN PLACE OF THERMACUT PARTS. VALID FROM MAY 2017 • PREVIOUS VERSION IS NO LONGER VALID. © COPYRIGHT 2017 BY THERMACUT® CZECH REPUBLIC. ALL RIGHTS RESERVED.