

**SMART SOLUTION** OF REPLACEMENT PARTS SUITABLE FOR ESAB® TORCH PT-600™

# OUR SOLUTION = COST SAVINGS

due to the use of our shorter electrode instead of standard long electrode

**BENEFITS:**

- Lower price
- Easy to use - Plug & Play (No special system set up required)
- Equal performance - Silver PRO™ design



## ORIGINAL CONFIGURATION (ABOVE) REPLACED WITH TMT SMART SOLUTION (BELOW)

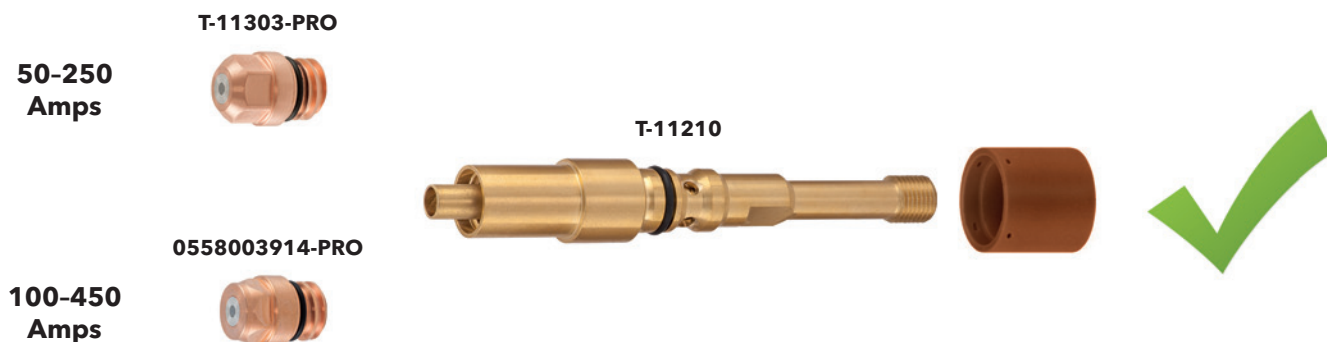

## SMART SOLUTION OF REPLACEMENT PARTS SUITABLE FOR ESAB® TORCH PT-600™

### HOW TO REPLACE YOUR ORIGINAL CONFIGURATION WITH OUR SMART SOLUTION.

1. Remove electrode holder from the torch body with the electrode holder removal tool #0558004611 or our electrode holder removal tool #T-11202. Lugs on the end of the holder removal tool will engage in slots on the holder.
2. For installing of our new electrode holder use the Electrode Holder Removal Tool #0558003918.

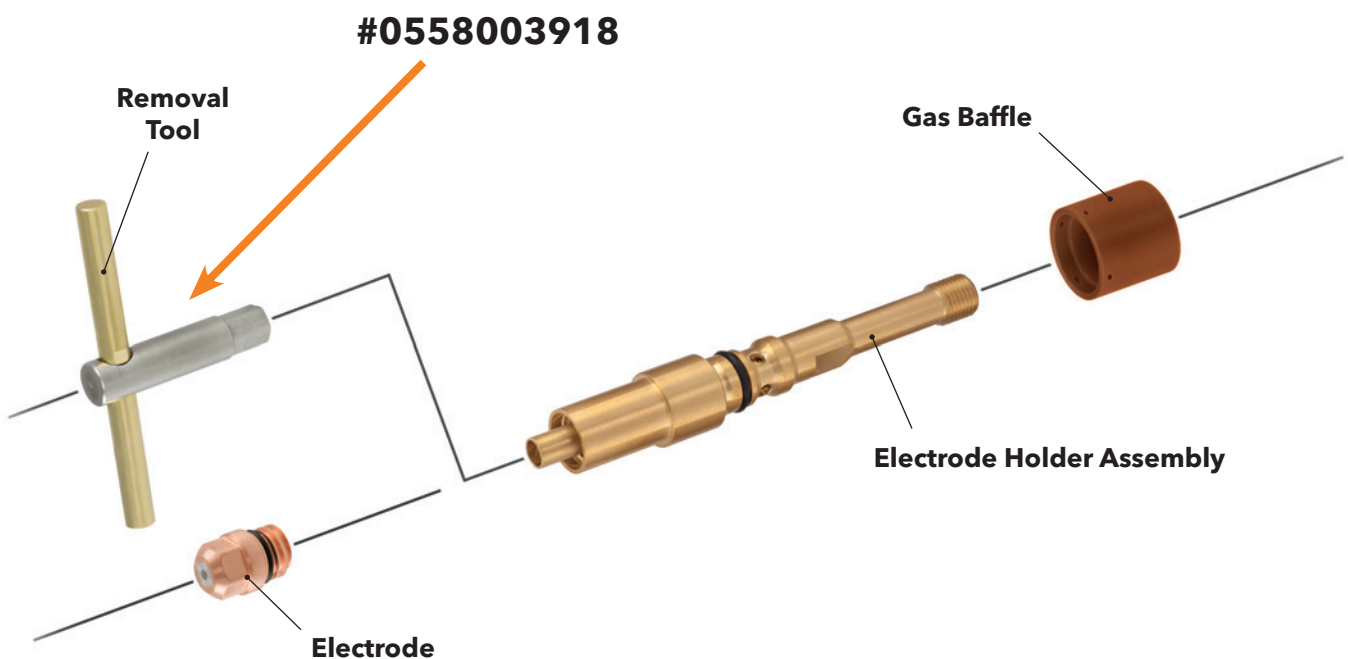

**NOTE:** Before assembling please apply a thin film of silicone lubricant (our ref. No. T-0994) on all o-rings to avoid leakage.

THERMACUT®, FHT-EX® and EX-TRAFIRE® are registered trademarks of THERMACUT, k.s. and may be registered in Czech Republic and/or other countries. All other trademarks are properties of their respective owners. Thermacut is no way affiliated with ESAB®.