

A GLOBAL PROVIDER OF THERMAL CUTTING TECHNOLOGY.

THE THERMACUT COMPANY AS TRADITIONAL PRODUCER WITH HIGH AND STABLE QUALITY OFFERS REPLACEMENT PARTS SUITABLE FOR PLASMA CUTTING SYSTEM AJAN® HP260A™ MILD STEEL

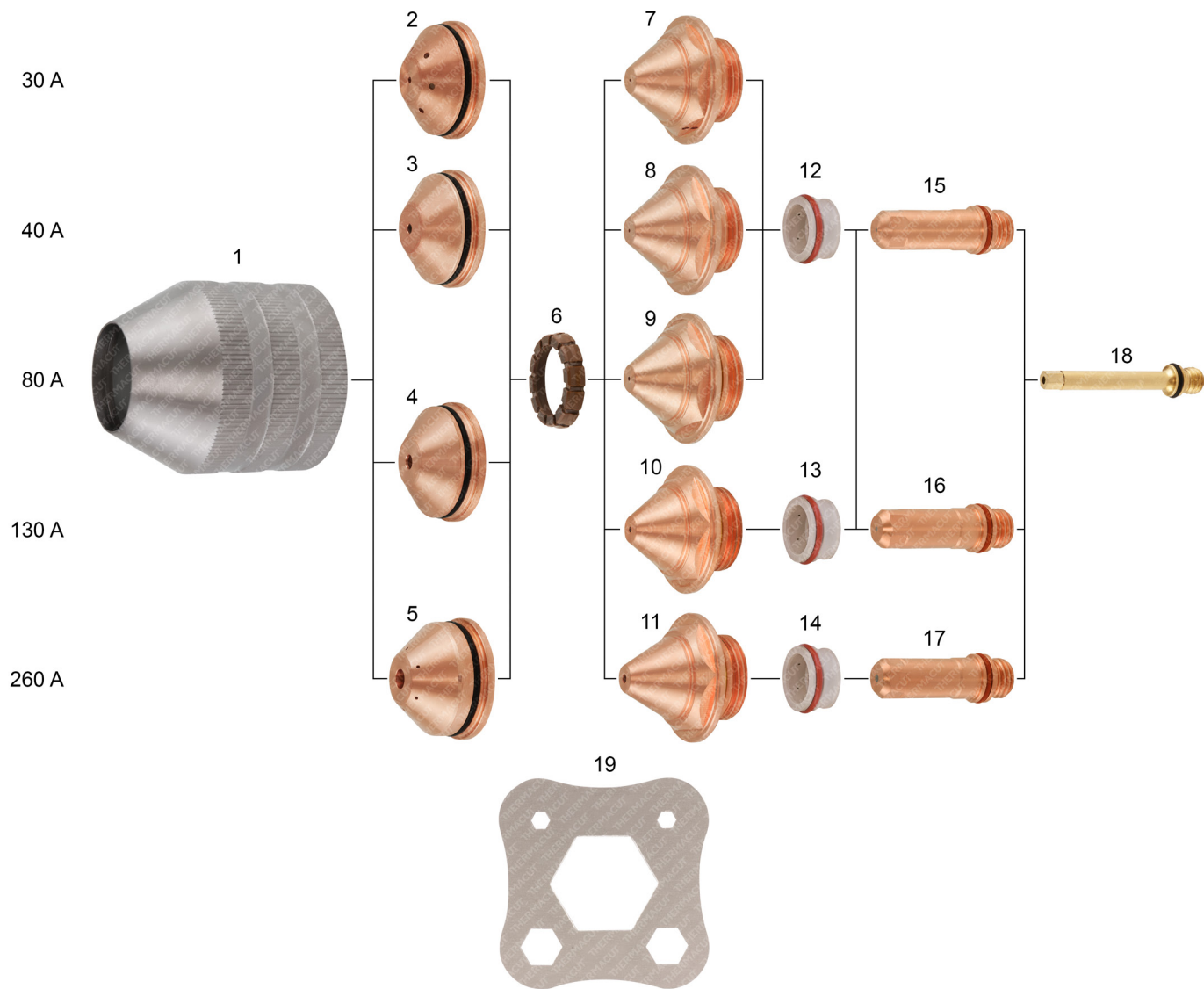

Item	Part No.	Ref. No.	Description	Std. Pkg.	Item	Part No.	Ref. No.	Description	Std. Pkg.
*1.	T-11408	SC2-UR	Shield Cap 30–260A	1	11.	T-11333	N7	Nozzle 260A	1
2.	T-11334	S1	Shield 30A	1	*12.	T-11338	SW1-UR	Swirl Ring 30–80A	1
3.	T-11335	S2	Shield 40A	1	*13.	T-11339	SW2-UR	Swirl Ring 130A	1
4.	T-11336	S3	Shield 80/130A	1	*14.	T-11340	SW3-UR	Swirl Ring 260A	1
5.	T-11337	S4	Shield 260A	1	15.	T-11341	E0	Electrode 30–80A	1
6.	T-11328	G1	Gas Ring 30–260A	1	16.	T-11342	E1	Electrode 130A	1
7.	T-11329	N1	Nozzle 30A	1	17.	T-11343	E3	Electrode 260A	1
8.	T-11330	N2	Nozzle 40A	1	18.	T-11327	B1	Cooling Tube	1
9.	T-11331	N3	Nozzle 80A	1	*19.	T-11351	100-07-106535-UR	Consumable removal tool	1
10.	T-11332	N5	Nozzle 130A	1					

\* FULLY INTERCHANGEABLE AND COMPATIBLE WITH ORIGINAL PARTS, BUT DIFFERS FROM ORIGINAL DESIGN

## THE THERMACUT DIFFERENCE:

### THERMACUT PROVIDES YOU WITH THE CARE YOU NEED FOR YOUR COMPLEX PLASMA CUTTING SYSTEM

**Your plasma cutting system is a complex piece of equipment. Thermacut offers not only replacement consumables, but also replacement torches and leads. We also offer you advice and training from our experienced Thermacut specialists to help you get the most out of your equipment.**

## OUR GOAL IS TO PROVIDE A COMPLETE CARE NETWORK FOR OUR CUSTOMERS, INCLUDING:

- Free consumable samples: put our consumables to the test on your plasma cutting system.
- **For more information please call: +420 556 423 440.**
- Supply our customers with a complete range of consumables, torches, and leads.
- Free introductory training for your plasma cutting operator.
- Providing free inspections of your torches and lead assemblies.
- Provide repairs for your damaged torches and lead assemblies.
- Training based on the most commonly-used plasma cutting systems in our lab.
- Additional products for use in the metal-cutting industry including laser and oxy-fuel.
- Control of technical conditions of cutting system.
- Measuring of conductivity of the coolant.

## REASONS TO BUY THERMACUT PARTS:

- Our quality is equal to OEM quality, but with a much more reasonable cost.
- Our Sales Representatives not only assist you with purchasing our products, but are also technically trained and able to provide troubleshooting help as well as advice be it over the phone or on-site.
- We are able to provide you with not just consumables, but also replacement torches and lead assemblies.
- We offer the ability to repair your worn or damaged torch and lead sets.
- We can provide technical training focused on the most commonly-used plasma cutting systems.